

1	A	SQUARE FEET	DIMENSIONS	CEILING HEIGHT	THEATER SEATING	BANQUET SEATING	RECEPTION	CLASSROOM SEATING
A1 - A6 COMBINED	17,130	96' x 180'	20'	1,680	1,000	2,468	1,000	
A1 - A6 EACH ROOM	2,827	48' x 60'	20'	280	136	400	150	
A7	1,925	39' x 48'	12'	180	112	260	110	
A8	1,981	40' x 48'	12'	180	112	270	110	
A9	1,994	40.5' x 48'	12'	180	112	270	110	
A10	2,018	40.5' x 48'	12'	180	112	270	110	
A11	1,967	40' x 48'	12'	180	112	270	110	
A12	1,974	40' x 48'	12'	180	112	270	110	
A13	2,012	40.5' x 48'	12'	180	112	270	110	
A14	877	26.5' x 33'	12'	60	32	100	30	
A15	845	26' x 33'	12'	60	32	100	30	
A16	1,708	35.5' x 48'	12'	154	72	225	76	
A17	1,687	35' x 48'	12'	154	72	225	76	
A18	1,644	34' x 48'	12'	154	72	225	76	
A19	1,898	40.5' x 47'	12'	180	96	90	100	
A20	1,899	40.5' x 47'	12'	180	96	90	100	
2	C	SQUARE FEET	DIMENSIONS	CEILING HEIGHT	THEATER SEATING	BANQUET SEATING	RECEPTION	CLASSROOM SEATING
C1	3,142	43' x 71'	25'	308	144	400	160	
C2	3,121	42' x 71'	25'	306	144	400	160	
C3	3,250	43' x 71'	25'	308	144	400	160	
C4	10,420	79' x 130'	25'	1,031	512	1,400	540	
3	D	SQUARE FEET	DIMENSIONS	CEILING HEIGHT	THEATER SEATING	BANQUET SEATING	RECEPTION	CLASSROOM SEATING
D1	3,248	43' x 71'	25'	308	144	400	160	
D2	3,120	42' x 71'	25'	306	144	400	160	
D3	3,140	43' x 71'	25'	308	144	400	160	
D4	1,804	37' x 50'	17'	187	88	250	96	
D5	1,805	37' x 50'	17'	189	88	250	96	
D6	1,761	36' x 48'	17'	176	88	240	90	
D7	1,762	36' x 48'	17'	176	88	240	90	
D8	1,286	31' x 41'	17'	130	64	175	64	
D9	1,312	31' x 41'	17'	130	64	175	64	
D10	1,284	31' x 41'	17'	128	64	175	64	
BALLROOM	29,716	130' x 224'	25'	2,970	1,440	4,100	1,800	
4	E	SQUARE FEET	DIMENSIONS	CEILING HEIGHT	THEATER SEATING	BANQUET SEATING	RECEPTION	CLASSROOM SEATING
E1	1,193	48' x 25'	17'	121	64	150	60	
E2	1,587	48' x 29'	17'	141	64	175	64	
E3	1,196	48' x 25'	17'	121	64	150	60	
5	F	SQUARE FEET	DIMENSIONS	CEILING HEIGHT	THEATER SEATING	BANQUET SEATING	RECEPTION	CLASSROOM SEATING
F1	2,819	47' x 58'	16'	272	200	375	120	
F2	2,494	41' x 58'	16'	238	172	325	140	
F3	2,496	42' x 58'	16'	244	172	325	140	
F4	2,164	37' x 58'	16'	220	172	300	140	
F5	1,763	37' x 50'	16'	195	144	250	120	
F6	2,034	42' x 50'	16'	210	160	275	120	
F7	2,032	41' x 50'	16'	205	152	275	12	
F8	2,297	47' x 50'	16'	235	172	300	140	
F1 - F8	19,393	108' x 180'	16'	2,000	1,500	2,600	1,300	
F9	1,470	32' x 47'	17'	150	72	200	76	
F10	3,310	67' x 52'	17'	340	160	450	176	
6	MEZZ	SQUARE FEET	DIMENSIONS	CEILING HEIGHT	THEATER SEATING	BANQUET SEATING	RECEPTION	CLASSROOM SEATING
M1*	569	17' x 20'	9'	24	16	48	16	
M2	603	31' x 20'	9'	48	24	88	32	
M3	603	29.5' x 20'	9'	48	24	84	32	
M4	603	29.5' x 20'	9'	48	24	84	32	
M5	440	20' x 20'	9'	24	16	56	16	
M6	564	28' x 19'	9'	48	24	75	32	
<b>MEETING ROOMS / TOTAL SQ FT: 109,836</b>								

\* Room M1 also includes a permanent wet bar area of 220 sq. ft.

7		SQUARE FEET	DIMENSIONS	CEILING HEIGHT	RECEPTION
Exhibit Hall Pre-Function A	14,966	40' x 313'	19'	---	
Pre-Function A	18,404	---	10'	---	
Public Dining	3,344	30' x 118'	21'	---	
Exhibit Hall Pre-Function B	10,637	35' x 354'	21'	---	
Pre-Function C	3,993	31' x 126'	21'	---	
Pre-Function D	8,355	30' x 226'	21'	---	
Pre-Function E	4,844	30' x 180'	21'	---	
Pre-Function F	7,056	32' x 200'	17'	---	
Mezzanine Pre-Function	1,661	---	9'	---	
Registration Lobby	21,765	72' x 205'	24'	2,500	
Ballroom Lobby	9,553	34' x 333'	18'	1,650	
Ballroom Registration Lobby	3,997	40.5' x 48'	21'	584	
<b>MULTI-USE PRE-FUNCTION / TOTAL SQ FT: 108,762</b>					

8		SQUARE FEET	DIMENSIONS	CEILING HEIGHT	THEATER SEATING	BANQUET SEATING	RECEPTION	CLASSROOM SEATING	10' x 10' BOOTHS
Exhibit Hall 1	73,108	480' x 180'	34'	7,500	3,700	8,700	4,000	402	
1A	20,316	120' x 180'	34'	2,000	950	2,250	1,000	111	
1B	20,627	120' x 180'	34'	2,000	950	2,250	1,000	115	
1C	32,007	275' x 180'	34'	3,000	1,500	4,000	1,700	169	
Exhibit Hall 2	120,957	480' x 245'	34'	11,500	6,300	12,000	6,700	643	
Exhibit Hall 3	60,348	200' x 300'	34'	5,800	3,100	5,800	3,200	336	
Exhibit Hall 4	69,890	180' x 360'	34'	6,500	3,500	6,700	3,800	395	
Exhibit Hall 5	49,209	150' x 330'	34'	4,800	2,500	6,400	2,600	292	
<b>EXHIBIT HALLS / TOTAL SQ FT: 382,303</b>									

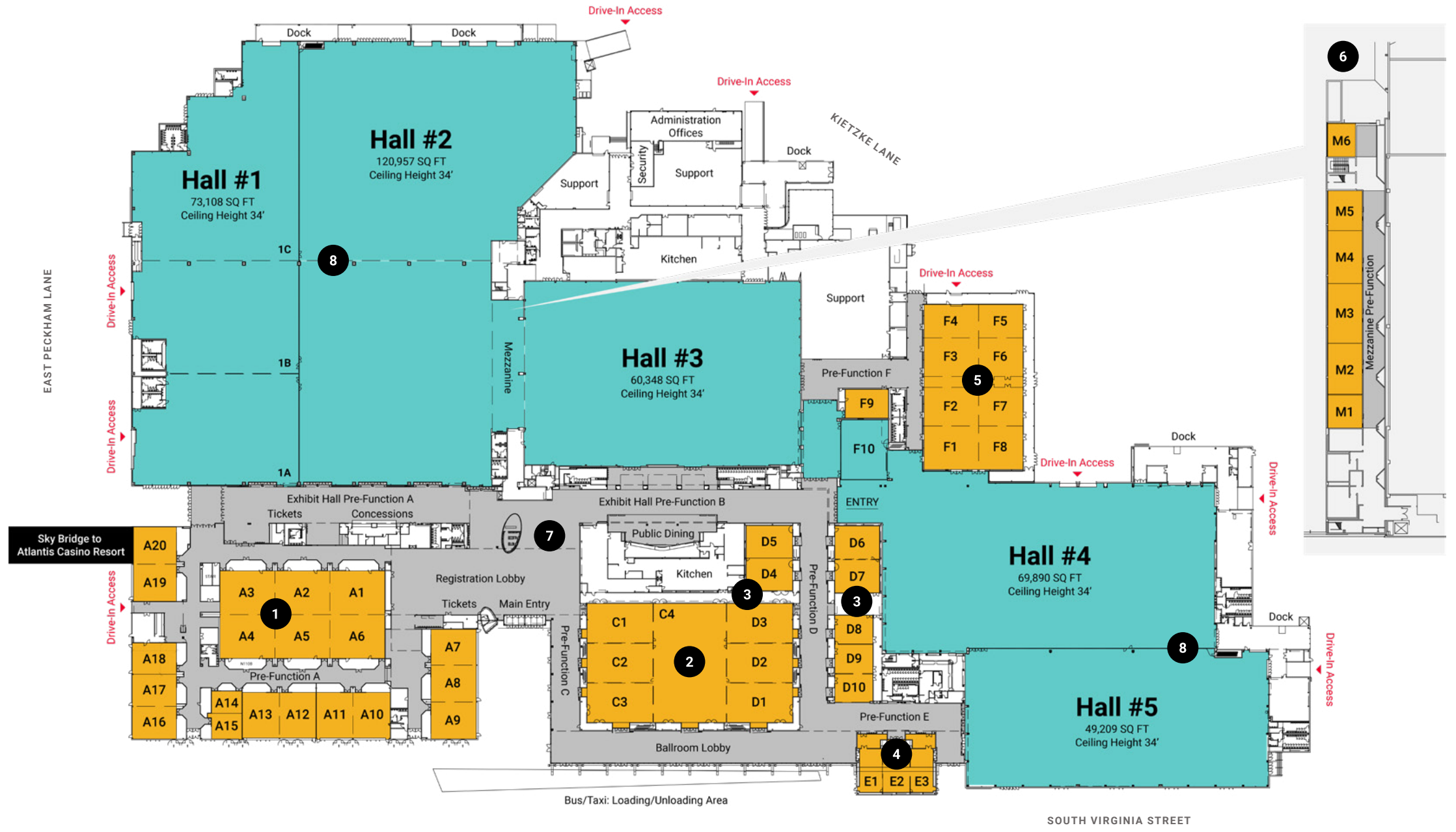

**Total Sq ft: 600,901**

Includes Exhibit Halls, Ballroom, Meeting Rooms and Pre-Function Areas